

Country Club Estates

FLORIDA Approx. 1,844 Sq. Ft. • 3 Bedrooms • 2 Bathrooms • 2-Car Garage



TRADITIONAL



MEDITERRANEAN



FRENCH COUNTRY

©2021 Landsea Homes US Corporation. LANDSEA® and LIVE IN YOUR ELEMENT® are federally registered trademarks of Landsea or its licensors. Plans, pricing, product information, square footage, amenities and community/building information are subject to change without notice or obligation. Photographs, renderings, virtual tours and floor plans are for representational purposes only and may not reflect the exact features or dimensions of your home. Models shown do not reflect racial or other preference. Homes shown do not represent actual homesites. Square footages are approximate. Some features and options shown may not be offered in your community/building. Please see the actual purchase agreement for additional information, disclosures and disclaimers relating to your home and its features. All rights reserved and strictly enforced. This is not an offering where prohibited by law. No information contained herein shall be deemed to constitute a representation or warranty of any kind. Please consult a Landsea Homes sales representative for details. Mercedes Premier Realty CQ1040509. 🏠

LANDSEA
HOMES
Live in your element®

Country Club Estates

FLORIDA Approx. 1,844 Sq. Ft. • 3 Bedrooms • 2 Bathrooms • 2-Car Garage



©2021 Landsea Homes US Corporation. LANDSEA® and LIVE IN YOUR ELEMENT® are federally registered trademarks of Landsea or its licensors. Plans, pricing, product information, square footage, amenities and community/building information are subject to change without notice or obligation. Photographs, renderings, virtual tours and floor plans are for representational purposes only and may not reflect the exact features or dimensions of your home. Models shown do not reflect racial or other preference. Homes shown do not represent actual homesites. Square footages are approximate. Some features and options shown may not be offered in your community/building. Please see the actual purchase agreement for additional information, disclosures and disclaimers relating to your home and its features. All rights reserved and strictly enforced. This is not an offering where prohibited by law. No information contained herein shall be deemed to constitute a representation or warranty of any kind. Please consult a Landsea Homes sales representative for details. Mercedes Premier Realty CQ1040509. 🏠

LANDSEA
HOMES
Live in your element®

Country Club Estates

FLORIDA Approx. 1,844 Sq. Ft. • 3 Bedrooms • 2 Bathrooms • 2-Car Garage

OPTIONAL FEATURES

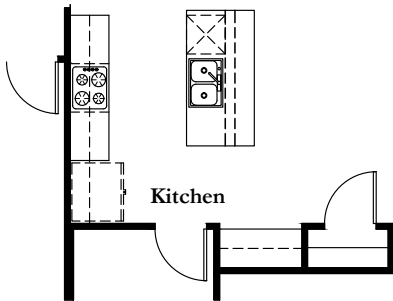

OPTIONAL DELUXE KITCHEN

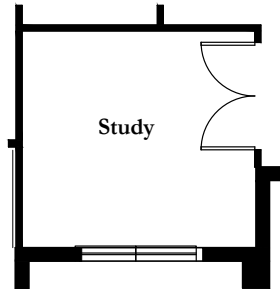

OPTIONAL STUDY ILO
FLEX SPACE

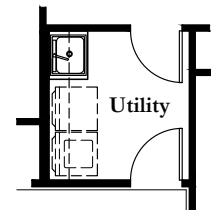

OPTIONAL DELUXE
UTILITY

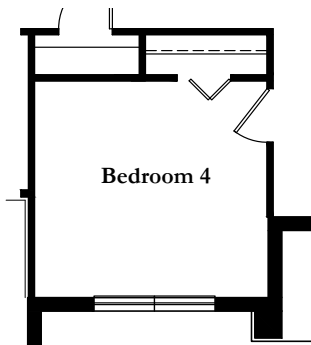

OPTIONAL BEDROOM 4
ILO FLEX SPACE

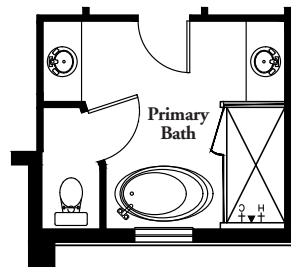

OPTIONAL DELUXE
PRIMARY BATH

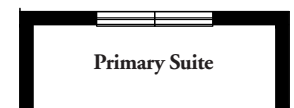

OPTIONAL DOUBLE WINDOWS
AT PRIMARY SUITE

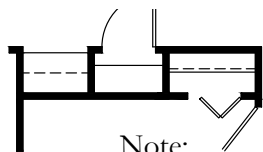

Note:
*BEDROOM 4 CLOSET LAYOUT
CHANGES WHEN COMBINED WITH
OPTIONAL DELUXE KITCHEN

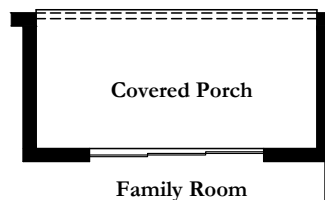

OPTIONAL 9' SLIDER
AT FAMILY ROOM

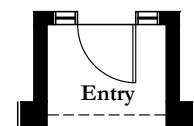

OPTIONAL ENTRY
WITH SIDELIGHTS

Country Club Estates

FLORIDA Approx. 1,844 Sq. Ft. • 3 Bedrooms • 2 Bathrooms • 2-Car Garage

OPTIONAL FEATURES

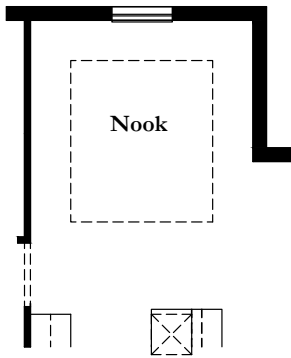

OPTIONAL TRAY
AT NOOK

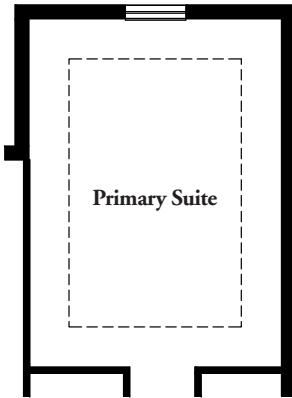

OPTIONAL TRAY
AT PRIMARY SUITE

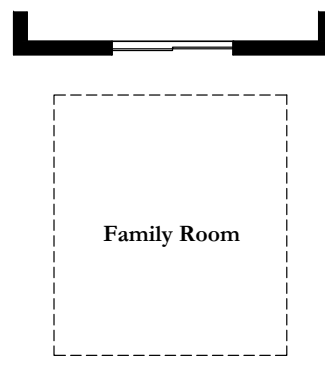

OPTIONAL TRAY
AT FAMILY ROOM

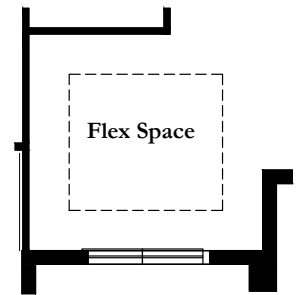

OPTIONAL TRAY
AT FLEX SPACE

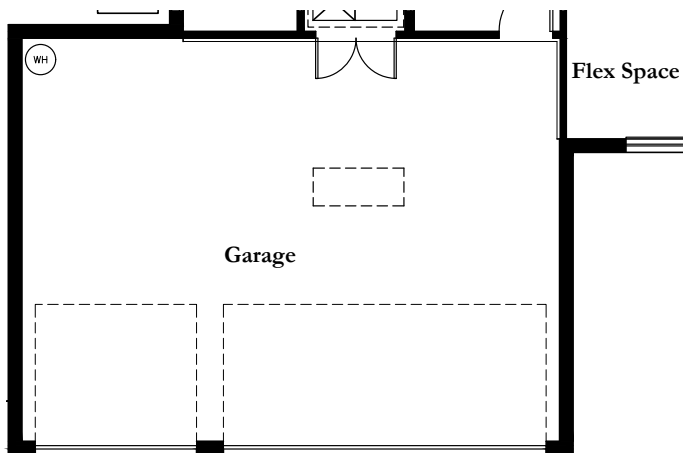

OPTIONAL 3 CAR GARAGE

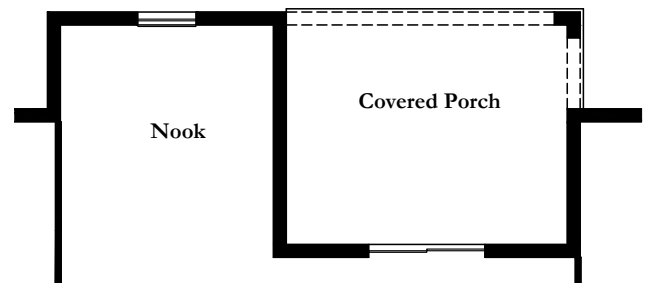

OPTIONAL 5' EXTENSION
AT NOOK & COVERED PATIO